

NOTES:  
 • ALL PROPERTY CONNECTIONS ARE #100 uPVC-U S100



SHEET 3

**REGISTERED SURVEYOR'S CERTIFICATION**

VERIS AUSTRALIA PTY LTD, hereby certify that the vertical and horizontal locations and dimensions shown on this plan are a true and correct record and were located by survey.

Registered Surveyor (Sig) \_\_\_\_\_ Reg. Surveyor No. 6448 Date: 31/10/2023  
 (DELEGATE)

**ENGINEER'S CERTIFICATION**

CHRIS CAMP, hereby certify that:

- The information contained in this drawing / document is in compliance with approved drawings and design.
- The new water and sewerage works defined by this drawing have been designed and constructed in accordance with the SEQ Code.
- This represents an accurate record of as-constructed works.
- I accept responsibility for the information contained in this drawing / document.

RPEQ (signature) \_\_\_\_\_ RPEQ No. 4944 Date: 15/11/2023

**COORDINATE DATUM NOTE:**  
 HORIZONTAL COORDINATES(E,N) SUPPLIED ARE MAPPING GRID OF AUSTRALIA(MGA), ZONE 56 BASED ON THE UNIVERSAL TRANSVERSE MERCATOR PROJECTION AND THE GEOCENTRIC DATUM OF AUSTRALIA 1994.  
 HORIZONTAL DATUM DERIVED FROM PM33280, E 492232.092, N 7002357.242.  
 LEVELS SUPPLIED ARE ON THE AUSTRALIAN HEIGHT DATUM(AHD)  
 LEVEL DATUM DERIVED FROM PSM108673 RL 17.338 (AHD)

\*\*Note  
 The Hatched Suffix indicates the use of a Design Level.  
 eg. SL 20.519# xx

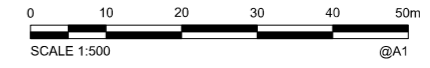

**AS CONSTRUCTED**

<b>A1</b>	E	1/09/2023	UPDATE PIPE CLASS 1/39-10/1	GJF	MJT				
	D	18/08/2023	UPDATE PIPE 15/1-14/1	GJF	MJT				
	C	10/08/2023	FINAL	PL	MJT				
	B	24/01/2023	CHANGING SEWER MAIN STATUS TO EXISTING	JMc	MJT				
	F	31/10/2023	MODIFY LINES 1 + 39	JMc	MJT				
INDEX	DATE	REVISIONS	DRAWN	CHECKED	PASSED		INITIALS	DATE	

CONSULTING SURVEYOR

**veris**

BRISBANE 075 3888 4700 WHITSUNDAYS 075 4948 8800  
 MACKAY 075 4957 9700 CAIRNS 075 4352 9408  
 veris.com.au  
 ACRN 615 735 727  
 Veris Australia Pty Ltd

**COVEY ASSOCIATES PTY LTD**

Consulting Civil & Structural Engineers  
 Project Management & Planning

124 DUPORTH AVENUE Ph (07) 5443 7777  
 MAROOCHYDORE QLD 4558 Fax (07) 5443 7577  
 E-MAIL: engineers@covey.com.au



**Unitywater**

OPW :201901397750  
 RIVERPARKS ESTATE  
 PAULS ROAD UPPER CABOOLTURE  
 STAGE 28 SEWER

SHEET 1 OF 3 SHEETS	SCALE 1:500
REVISION DATE 31/10/2023	REVISION F
DISCIPLINE CODE C	
DRAWING NO. U-2022-4280-AS	

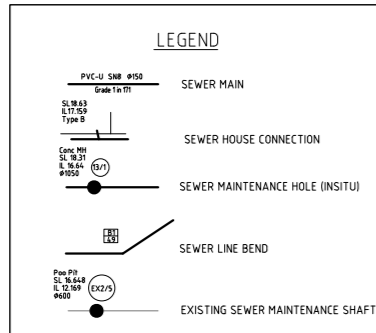

NOTES:  
 • ALL PROPERTY CONNECTIONS ARE Ø100 uPVC-U SN10

**ENGINEER'S CERTIFICATION**

I, CHRIS CAMP, hereby certify that:

- The information contained in this drawing / document is in compliance with approved drawings and design.
- The new water and sewerage works defined by this drawing have been designed and constructed in accordance with the SEO Code.
- This represents an accurate record of as-constructed works.
- I accept responsibility for the information contained in this drawing / document.

*Chris Camp*  
 RPEQ (signature) RPEQ No. 4944 Date: 15/11/2023

**REGISTERED SURVEYOR'S CERTIFICATION**

I, VERIS AUSTRALIA PTY LTD, hereby certify that the vertical and horizontal locations and dimensions shown on this plan are a true and correct record and were located by survey.

*[Signature]*  
 Registered Surveyor (sig) Reg. Surveyor No. 6448 Date: 31/10/2023  
 (DELEGATE)

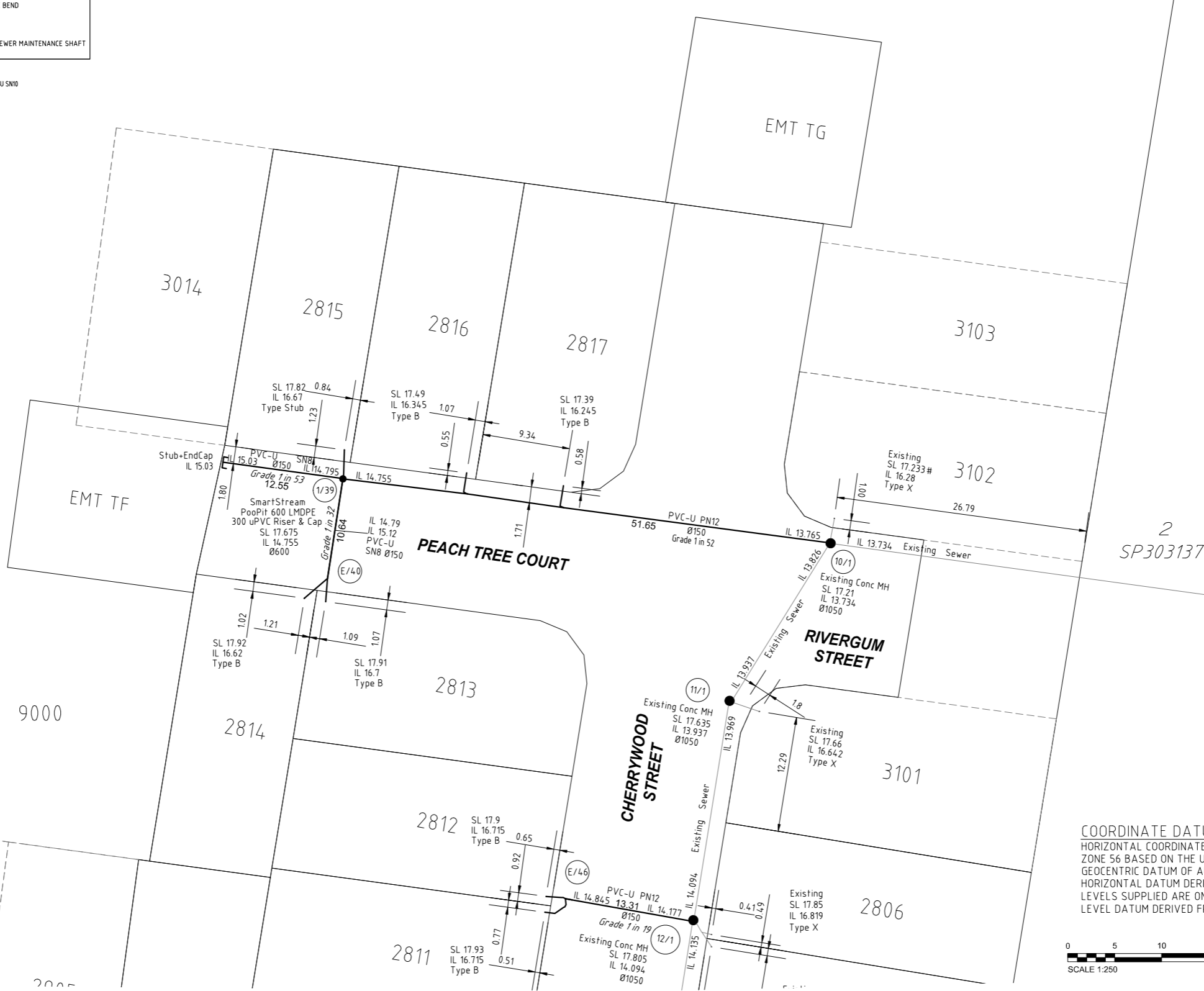

Note:  
 The hatched suffix indicates the use of a Design Level.  
 eg. SL 20.519# \*\*

**COORDINATE DATUM NOTE:**  
 HORIZONTAL COORDINATES(E,N) SUPPLIED ARE MAPPING GRID OF AUSTRALIA(MGA), ZONE 56 BASED ON THE UNIVERSAL TRANSVERSE MERCATOR PROJECTION AND THE GEOCENTRIC DATUM OF AUSTRALIA 1994.  
 HORIZONTAL DATUM DERIVED FROM PM33280, E 492232.092, N 7002357.242.  
 LEVELS SUPPLIED ARE ON THE AUSTRALIAN HEIGHT DATUM(AHD).  
 LEVEL DATUM DERIVED FROM PSM108673 RL 17.338 (AHD)

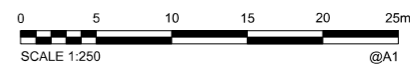

**AS CONSTRUCTED**

<b>A1</b>	E	01/09/2023	UPDATE PIPE CLASS 1/39-10-1	GJF	MJT				
	D	18/08/2023	UPDATE PIPE 15/1-14/1	GJF	MJT				
	C	10/08/2023	FINAL	PL	MJT	DRAWN	JMc		
	B	24/01/2023	CHANGING SEWER MAIN STATUS TO EXISTING	JMc	MJT	CHECKED	MJT		
	F	31/10/2023	MODIFY LINES 1 + 39	JMc	MJT	PASSED			
INDEX	DATE	REVISIONS		DRAWN	CHECKED	PASSED	INITIALS	DATE	

CONSULTING SURVEYOR

**veris**

BRISBANE WHITSUNDAYS  
 (07) 3900 9700 (07) 4960 6600  
 MACKAY CAIRNS  
 (07) 4967 9700 (07) 4352 9400  
 VERIS.COM.AU  
 ACN 615 735 727  
 Veris Australia Pty Ltd

CONSULTING ENGINEER

**COVEY ASSOCIATES PTY LTD**

Consulting Civil & Structural Engineers  
 Project Management & Planning

124 DUPORTH AVENUE Ph (07) 5443 7777  
 MAROOCHYDORE QLD 4668 Fax (07) 5443 7577  
 E-MAIL: engineers@covey.com.au

Unitywater

**Unitywater**

OPW - 201901397750  
 RIVERPARKS ESTATE  
 PAULS ROAD UPPER CABOOLTURE  
 STAGE 28 SEWER

SHEET 2 OF 3 SHEETS	SCALE 1:250
REVISION DATE 31/10/2023	REVISION F
DISCIPLINE CODE C	
DRAWING NO. U-2022-4280-AS	

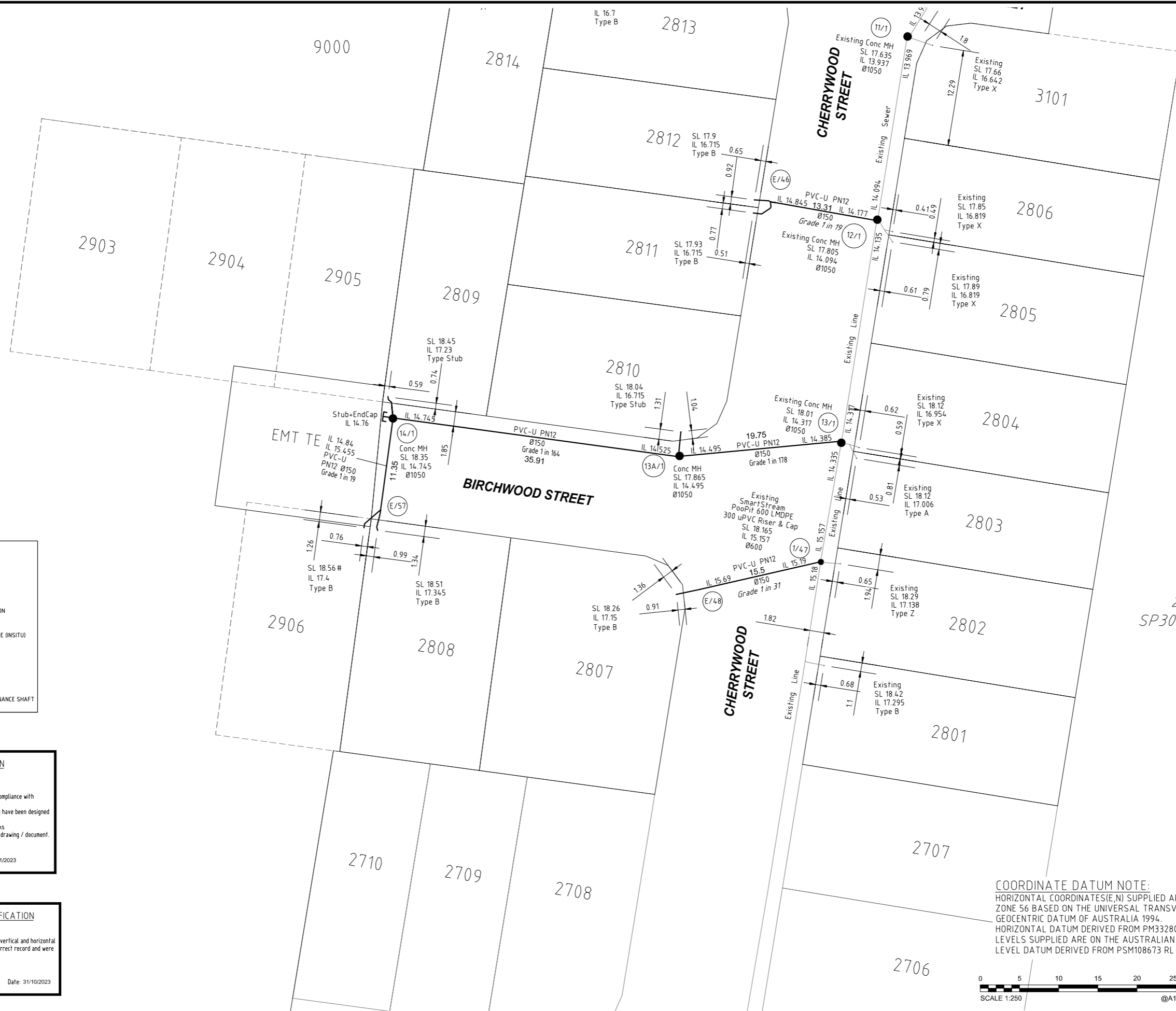

2  
SP303137

\*\*Note  
The Hatched Suffix  
indicates the use of a  
Design Level.  
eg. SL 20.519# \*\*

**COORDINATE DATUM NOTE:**  
HORIZONTAL COORDINATES(E,N) SUPPLIED ARE MAPPING GRID OF AUSTRALIA(MGA), ZONE 56 BASED ON THE UNIVERSAL TRANSVERSE MERCATOR PROJECTION AND THE GEOCENTRIC DATUM OF AUSTRALIA 1994.  
HORIZONTAL DATUM DERIVED FROM PM33280, E 492232.092, N 7002357.242.  
LEVELS SUPPLIED ARE ON THE AUSTRALIAN HEIGHT DATUM(AHD)  
LEVEL DATUM DERIVED FROM PSM108673 RL 17.338 (AHD)

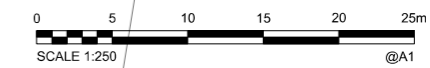

**AS CONSTRUCTED**

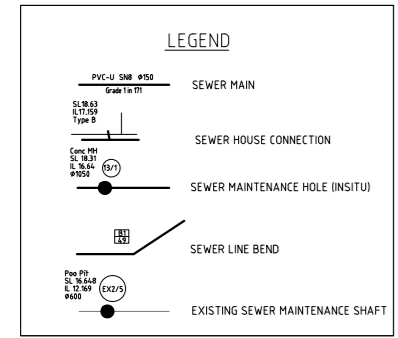

**NOTES:**  
• ALL PROPERTY CONNECTIONS ARE Ø100 uPVC-U S110

**ENGINEER'S CERTIFICATION**

I, CHRIS CAMP, hereby certify that:  
1. The information contained in this drawing / document is in compliance with approved drawings and design.  
2. The new water and sewerage works defined by this drawing have been designed and constructed in accordance with the SEQ Code.  
3. This represents an accurate record of as-constructed works.  
4. I accept responsibility for the information contained in this drawing / document.

RPEQ (signature) RPEQ No. 4944 Date: 15/11/2023

**REGISTERED SURVEYOR'S CERTIFICATION**

I, VERIS AUSTRALIA PTY LTD, hereby certify that the vertical and horizontal locations and dimensions shown on this plan are a true and correct record and were located by survey.

Registered Surveyor (sig) Reg. Surveyor No. 6448 Date: 31/10/2023 (DELEGATE)

<b>A1</b>	E	01/09/2023	UPDATE PIPE CLASS 1/39-10-1	GJF	MJT				
	D	18/08/2023	UPDATE PIPE 15/1-14/1	GJF	MJT				
	C	10/08/2023	FINAL	PL	MJT				
	B	24/01/2023	CHANGING SEWER MAIN STATUS TO EXISTING	JMc	MJT	CHECKED	MJT		
	F	31/10/2023	MODIFY LINES 1 + 39	JMc	MJT	PASSED			
	INDEX	DATE	REVISIONS	DRAWN	CHECKED	PASSED	INITIALS	DATE	

CONSULTING SURVEYOR

**veris**

BRISBANE WHITSUNDAYS  
15/1-30/4-01/10  
MACKAY CAIRNS  
(07) 4957 9700 (07) 4352 9400  
VERIS.COM.AU  
ACN 615 735 727  
Veris Australia Pty Ltd

CONSULTING ENGINEER

**COVEY ASSOCIATES PTY LTD**

Consulting Civil & Structural Engineers  
Project Management & Planning

124 DUPORTH AVENUE  
MAROOCHYDORE QLD 4558  
Ph (07) 5443 7777  
Fax (07) 5443 7577  
E-MAIL: engineers@covey.com.au



**Unitywater**

OPW : 201901397750  
RIVERPARKS ESTATE  
PAULS ROAD UPPER CABOOLTURE  
STAGE 28 SEWER

SHEET 3 OF 3 SHEETS	SCALE 1:250
REVISION DATE 31/10/2023	REVISION F
DISCIPLINE CODE C	
DRAWING NO. U-2022-4280-AS	

**COORDINATE DATUM NOTE:**  
 HORIZONTAL COORDINATES(E,N) SUPPLIED ARE MAPPING GRID OF AUSTRALIA(MGA), ZONE 56 BASED ON THE UNIVERSAL TRANSVERSE MERCATOR PROJECTION AND THE GEODCENTRIC DATUM OF AUSTRALIA 1994.  
 HORIZONTAL DATUM DERIVED FROM PM33280, E 492232.092, N 7002357.242.  
 LEVELS SUPPLIED ARE ON THE AUSTRALIAN HEIGHT DATUM(AHD)  
 LEVEL DATUM DERIVED FROM PSM108673 RL 17.338 (AHD)



**LEGEND**

	New Tee
	New Hydrant
	New Sluice Valve
	New End Cap
	New Taper
	New Water Service Conduit (Ø100 uPVC PN9)
	New Water Meter
	New Water House connection

⑤	Ø150 11.25° BEND
⑥	Ø150 22.5° BEND
⑦	Ø150 45° BEND
⑫	Ø300 90° BEND
⑳	Ø150xØ100 Tee
㉑	Ø150xØ150 Tee
㉒	Ø100 Sluice Valve
㉓	Ø150 Sluice Valve
㉔	Ø100 Fire Hydrant
㉕	Ø150 Fire Hydrant
㉖	Ø300 Fire Hydrant
㉗	Ø100 Temp Duck Foot Hydrant
㉘	Ø150 Temp Duck Foot Hydrant
㉙	Ø100 Dead End Tap
㉚	Ø150 Dead End Tap
㉛	Ø300 Dead End Tap
㉜	Ø100 Ready Tap
㉝	Ø150 Ready Tap

**REGISTERED SURVEYOR'S CERTIFICATION**

I, Veris Australia Pty Ltd, hereby certify that the vertical and horizontal locations and dimensions shown on this plan are a true and correct record and were located by survey.

*Alistair Byrom*  
 Registered Surveyor (sig) Reg. Surveyor No. 6448 Date: 4/09/2023  
 (Delegate)

**ENGINEER'S CERTIFICATION**

I, CHRIS CAMP, hereby certify that:

- The information contained in this drawing / document is in compliance with approved drawings and design.
- The new water and sewerage works defined by this drawing have been designed and constructed in accordance with the SEQ Code.
- This represents an accurate record of as-constructed works.
- I accept responsibility for the information contained in this drawing / document.

*Chris Camp*  
 RPEQ (signature) RPEQ No. 4944 Date: 15/11/2023

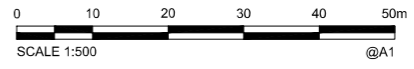

**AS CONSTRUCTED**

<b>A1</b>	B	24/08/2023	REMOVED END CAPS AND ADDED EXISTING WATERMAIN	PL	GJF		DRAWN	JMc/GJF	15/08/2023	CONSULTING SURVEYOR <b>veris</b> BRISBANE WHITSUNDAYS (07) 3566 4700 MACKAY CAIRNS (07) 4987 8700 VERIS.COM.AU ACN 615 735 727 Veris Australia Pty Ltd	CONSULTING ENGINEER <b>COVEY ASSOCIATES PTY LTD</b> Consulting Civil & Structural Engineers Project Management & Planning 124 DUPORTH AVENUE MAROOCHYDRE QLD 4558 Ph (07) 5443 7777 Fax (07) 5443 7577 E-MAIL: engineers@covey.com.au		<b>Unitywater</b> OPW: 201901397750 Riverparks Estate Pauls Road Upper Caboolture Stage 28	SHEET 1 OF 3 SHEETS	SCALE 1:500 @A1
	A	15/08/2023	ORIGINAL	JMc/GJF	MJT	PASSED	CHECKED	MJT	17/08/2023					REVISION B	
	INDEX	DATE	REVISIONS	DRAWN	CHECKED	PASSED	INITIALS	DATE							DISCIPLINE CODE C



**COORDINATE DATUM NOTE:**

HORIZONTAL COORDINATES(E,N) SUPPLIED ARE MAPPING GRID OF AUSTRALIA(MGA), ZONE 56 BASED ON THE UNIVERSAL TRANSVERSE MERCATOR PROJECTION AND THE GEOCENTRIC DATUM OF AUSTRALIA 1994.  
HORIZONTAL DATUM DERIVED FROM PM33280, E 492232.092, N 7002357.242.  
LEVELS SUPPLIED ARE ON THE AUSTRALIAN HEIGHT DATUM(AHD)  
LEVEL DATUM DERIVED FROM PSM108673 RL 17.338 (AHD)

**LEGEND**

- New Tee
- New Hydrant
- New Sluice Valve
- New End Cap
- New Taper
- New Water Service Conduit (Ø100 uPVC PN9)
- New Water Meter
- New Water House connection
- Ø150 11.25° BEND
- Ø150 22.5° BEND
- Ø150 45° BEND
- Ø300 90° BEND
- Ø150xØ100 Tee
- Ø150xØ150 Tee
- Ø100 Sluice Valve
- Ø150 Sluice Valve
- Ø100 Fire Hydrant
- Ø150 Fire Hydrant
- Ø300 Fire Hydrant
- Ø100 Temp Duck Foot Hydrant
- Ø150 Temp Duck Foot Hydrant
- Ø100 Dead End Tap
- Ø150 Dead End Tap
- Ø300 Dead End Tap
- Ø100 Ready Tap
- Ø150 Ready Tap

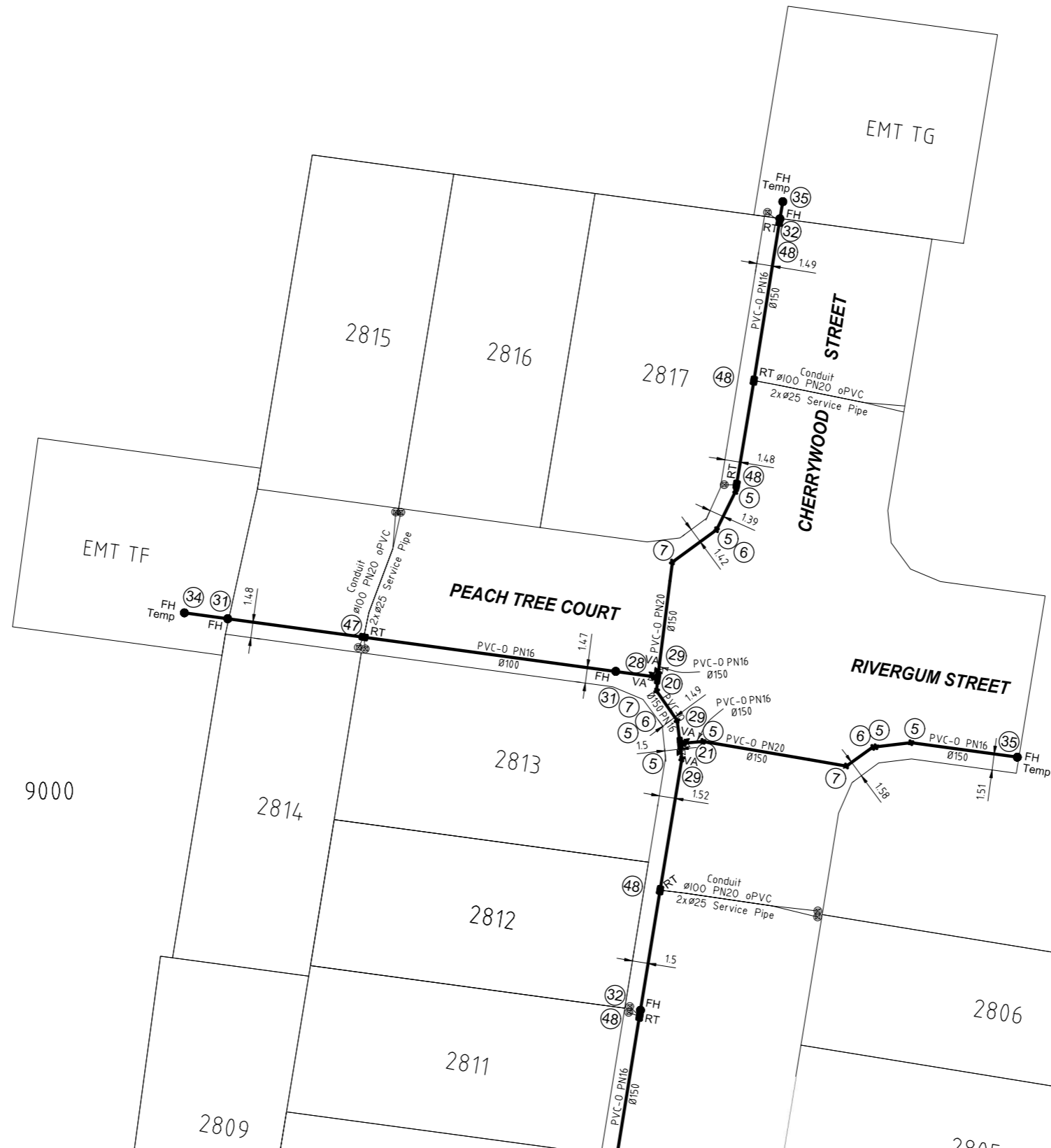

2  
SP303137

**REGISTERED SURVEYOR'S CERTIFICATION**

I, Veris Australia Pty Ltd, hereby certify that the vertical and horizontal locations and dimensions shown on this plan are a true and correct record and were located by survey.  
*Alistair Byrom*  
Registered Surveyor (sig) Reg. Surveyor No. 6448 Date: 4/09/2023

**ENGINEER'S CERTIFICATION**

CHRIS CAMP  
I, Chris Camp, hereby certify that:  
1. The information contained in this drawing / document is in compliance with approved drawings and design.  
2. The new water and sewerage works defined by this drawing have been designed and constructed in accordance with the SEQ Code.  
3. This represents an accurate record of as-constructed works  
4. I accept responsibility for the information contained in this drawing / document.  
*Chris Camp*  
RPEQ (signature) RPEQ No. 1944 Date: 15/11/2023

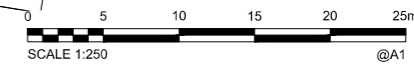

**AS CONSTRUCTED**

**A1**

INDEX	DATE	REVISIONS	DRAWN	CHECKED	PASSED	INITIALS	DATE
B	24/08/2023	REMOVED END CAPS AND ADDED EXISTING WATERMAIN	PL	GJF			
A	15/08/2023	ORIGINAL	JMc/GJF	MJT			

DRAWN	CHECKED	PASSED	INITIALS	DATE
JMc/GJF	MJT			15/08/2023
				17/08/2023

**CONSULTING SURVEYOR**  
**veris**  
BRISBANE WHITSUNDAYS  
071 3060 6100  
MACKAY CAIRNS  
071 4987 8700  
VERIS.COM.AU  
ACN 615 735 727  
Veris Australia Pty Ltd

**CONSULTING ENGINEER**  
**COVEY ASSOCIATES PTY LTD**  
Consulting Civil & Structural Engineers  
Project Management & Planning  
124 DUPORTH AVENUE  
MAROOCHDORE QLD 4558  
Ph (07) 5443 7777  
Fax (07) 5443 7577  
E-MAIL: engineers@covey.com.au

**Unitywater**

**Unitywater**  
DPW: 201901397750  
Riverparks Estate  
Pauls Road Upper Caboolture  
St age 28

SHEET 2 OF 3 SHEETS	SCALE 1:250 @A1
REVISION DATE 24/08/2023	REVISION B
DISCIPLINE CODE C	
DRAWING NO. U-2022-4280-AW	

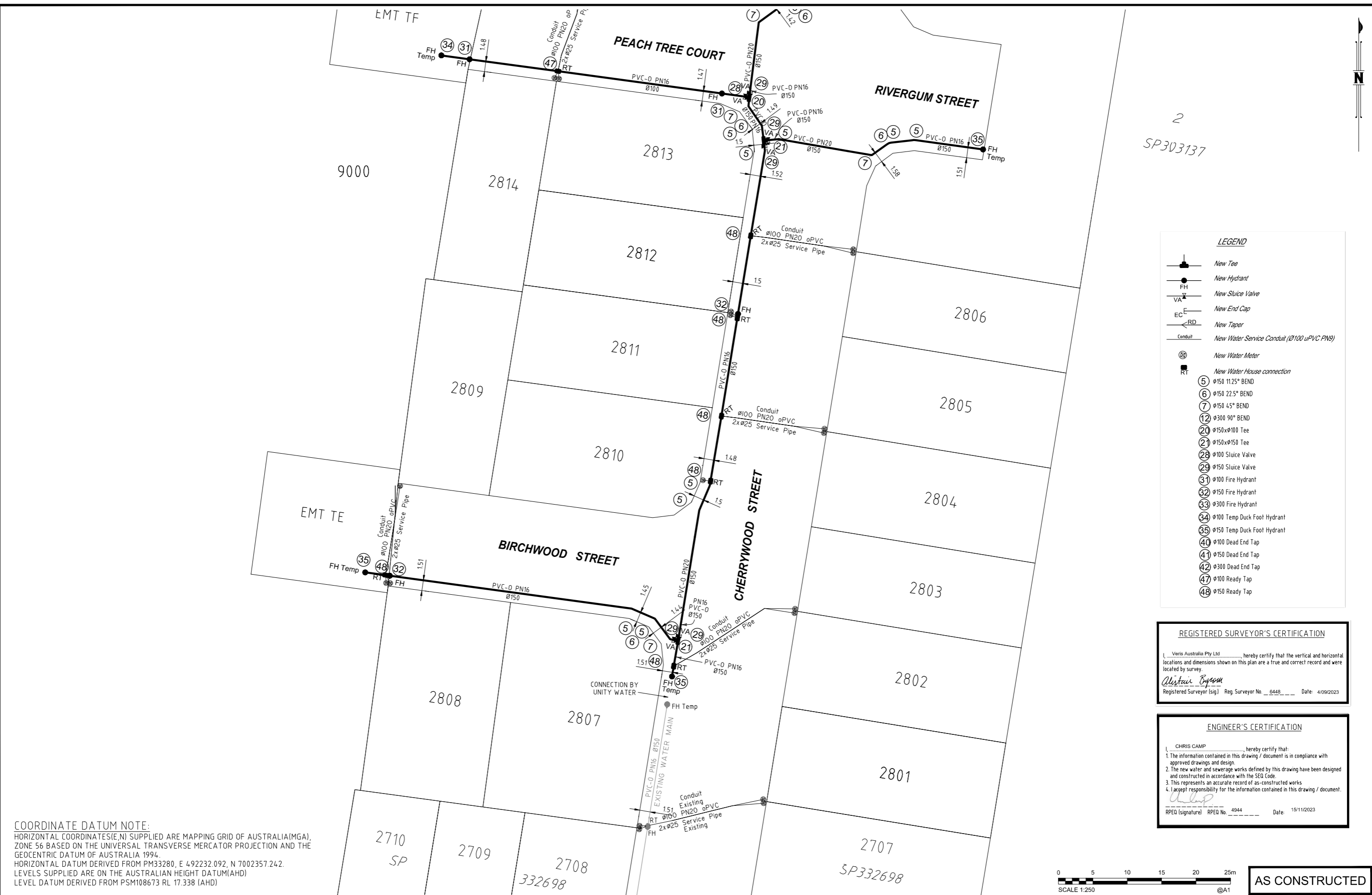

2  
SP303137

**LEGEND**

	New Tee
	New Hydrant
	New Sluice Valve
	New End Cap
	New Taper
	New Water Service Conduit (Ø100 uPVC PN9)
	New Water Meter
	New Water House connection
	Ø150 11.25° BEND
	Ø150 22.5° BEND
	Ø150 45° BEND
	Ø300 90° BEND
	Ø150xØ100 Tee
	Ø150xØ150 Tee
	Ø100 Sluice Valve
	Ø150 Sluice Valve
	Ø100 Fire Hydrant
	Ø150 Fire Hydrant
	Ø300 Fire Hydrant
	Ø100 Temp Duck Foot Hydrant
	Ø150 Temp Duck Foot Hydrant
	Ø100 Dead End Tap
	Ø150 Dead End Tap
	Ø300 Dead End Tap
	Ø100 Ready Tap
	Ø150 Ready Tap

**REGISTERED SURVEYOR'S CERTIFICATION**

I, Veris Australia Pty Ltd, hereby certify that the vertical and horizontal locations and dimensions shown on this plan are a true and correct record and were located by survey.

*Alister Byrom*  
Registered Surveyor [sig] Reg. Surveyor No. 0448 Date: 4/09/2023

**ENGINEER'S CERTIFICATION**

I, CHRIS CAMP, hereby certify that:

- The information contained in this drawing / document is in compliance with approved drawings and design.
- The new water and sewerage works defined by this drawing have been designed and constructed in accordance with the SEQ Code.
- This represents an accurate record of as-constructed works.
- I accept responsibility for the information contained in this drawing / document.

*Chris Camp*  
RPEQ (signature) RPEQ No. 4944 Date: 15/11/2023

**COORDINATE DATUM NOTE:**  
HORIZONTAL COORDINATES(E,N) SUPPLIED ARE MAPPING GRID OF AUSTRALIA(IMG), ZONE 56 BASED ON THE UNIVERSAL TRANSVERSE MERCATOR PROJECTION AND THE GEODCENTRIC DATUM OF AUSTRALIA 1994.  
HORIZONTAL DATUM DERIVED FROM PM33280, E 492232.092, N 7002357.242.  
LEVELS SUPPLIED ARE ON THE AUSTRALIAN HEIGHT DATUM(AHD)  
LEVEL DATUM DERIVED FROM PSM108673 RL 17.338 (AHD)

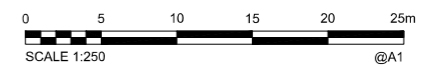

**AS CONSTRUCTED**

<b>A1</b>	B	24/08/2023	REMOVED END CAPS AND ADDED EXISTING WATERMAIN	PL	GJF		DRAWN	JMc/GJF	15/08/2023
	A	15/08/2023	ORIGINAL	JMc/GJF	MJT		CHECKED	MJT	17/08/2023
				DRAWN	CHECKED	PASSED		INITIALS	DATE
				DRAWN	CHECKED	PASSED		INITIALS	DATE

CONSULTING SURVEYOR

**veris**

BRISBANE WHITSUNDAYS  
071 3066 8100  
MACKAY CAIRNS  
071 4067 8700  
VERIS.COM.AU  
ACN 615 735 727  
Veris Australia Pty Ltd

CONSULTING ENGINEER

**COVEY ASSOCIATES PTY LTD**

Consulting Civil & Structural Engineers  
Project Management & Planning

124 DUPORTH AVENUE  
MAROOCHDORE QLD 4558 Ph (07) 5443 7777  
Fax (07) 5443 7577  
E-MAIL: engineers@covey.com.au

**Unitywater**

OPW: 201901397750  
Riverparks Estate  
Pauls Road Upper Caboolture  
Stage 28

SHEET 3 OF 3 SHEETS	SCALE 1:250 @A1
REVISION DATE 24/08/2023	REVISION B
DISCIPLINE CODE C	
DRAWING NO. U-2022-4280-AW	