



**REGISTERED SURVEYOR'S CERTIFICATION**

We, **VERIS AUSTRALIA PTY LTD**, hereby certify that the vertical and horizontal locations and dimensions shown on this plan are a true and correct record and were located by survey.

*Alistair Byrom*  
 Delegate Cadastral Surveyor (sig.) Reg. Surveyor No. 6448 Date: 19/04/23

**ENGINEER'S CERTIFICATION**

I, **BRENT MILTON**, being a Certified/Registered Engineer and  
 (Engineer's Name)  
 duly authorised representative of **COVEY ASSOCIATES PTY LTD**  
 (Consulting firm or company)

Hereby:-

- certify the information contained in this drawing/file is an accurate "as constructed" representation of the works;
- accept responsibility for the "as constructed" information contained in this drawing/file; and
- acknowledge the "as constructed" information contained in this drawing/file may be relied on by the Council and others.

Certification for Stage 27 by [Signature] on 10.05.2023  
 (Stage No) (Signature) (Date)

for **COVEY ASSOCIATES PTY LTD**  
 (Company Name)  
 Registered Professional Engineering Company of Queensland 27473  
 (Number)

**COORDINATE DATUM NOTE:**  
 HORIZONTAL COORDINATES(E,N) SUPPLIED ARE MAPPING GRID OF AUSTRALIA(MGA), ZONE 56 BASED ON THE UNIVERSAL TRANSVERSE MERCATOR PROJECTION AND THE GEOCENTRIC DATUM OF AUSTRALIA 1994.  
 HORIZONTAL DATUM DERIVED FROM PM33280, E 492232.092, N 7002357.242.  
 LEVELS SUPPLIED ARE ON THE AUSTRALIAN HEIGHT DATUM(AHD)  
 LEVEL DATUM DERIVED FROM PSM108673 RL 17.338 (AHD)

==Note  
 The Hatched Suffix  
 indicates the use of a  
 Design Feature:  
 eg. 7/1#  
 eg. SL 20.519# ==

DRAWING REVISIONS		REFERENCE DRAWINGS		DESIGN FILE No.	DESIGNED
REV.	REVISION DESCRIPTION	DRG. No.	DESCRIPTION	CONSTRUCT. No.	DATE
A	Original 24/11/2022			431132-27-ASW B	JMc
B	Final 17/04/2023				23/11/2022
				FIELD BOOK	MJT
				LOG BOOK	17/04/2023
				LEVEL DATUM	AHD
				DATUM	PM 108673 RL 17.338

**veris**

BRISBANE (07) 3656 4700 WHITSUNDAYS (07) 4945 6600  
 MACKAY (07) 4957 9700 CAIRNS (07) 4252 9400

veris.com.au  
 ACN 615 735 727  
 Veris Australia Pty Ltd

SCALE 1:750 ORIGINAL SIZE A1

**Moreton Bay**  
 Regional Council

**MORETON BAY REGIONAL COUNCIL**  
 CABOOLTURE DISTRICT OFFICE  
 2 HASKING STREET CABOOLTURE QLD 4510  
 PO BOX 159 CABOOLTURE QLD 4510  
 Telephone: (07) 5433 0100  
 Fax: (07) 5433 4000

**STAGE 27**  
**RIVERPARKS ESTATE**  
**AS CONSTRUCTED**  
**STORMWATER DRAINAGE**

MBRC SUBDIVISION REFERENCE	
DA/28428/2013/VCHG/1	
No. 1 OF 4 PLANS	
DRAWING NUMBER	REV.
431132-27-ASW	B

**REGISTERED SURVEYOR'S CERTIFICATION**

We, VERIS AUSTRALIA PTY LTD, hereby certify that the vertical and horizontal locations and dimensions shown on this plan are a true and correct record and were located by survey.

*Alister Byrom*  
 Delegate Cadastral Surveyor (sig.) Reg. Surveyor No. 6448 Date: 19/04/23

**ENGINEER'S CERTIFICATION**

I, BRENT MILTON, being a Certificated/Registered Engineer and  
 (Engineer's Name)  
 duly authorised representative of COVEY ASSOCIATES PTY LTD  
 (Consulting firm or company)

Hereby:-  
 • certify the information contained in this drawing/file is an accurate "as constructed" representation of the works;  
 • accept responsibility for the "as constructed" information contained in this drawing/file; and  
 • acknowledge the "as constructed" information contained in this drawing/file may be relied on by the Council and others.

Certification for Stage 27 by 10.05.2023  
 (Stage No) (Signature) (Date)

for COVEY ASSOCIATES PTY LTD  
 (Company Name)

Registered Professional Engineering Company of Queensland 27473  
 (Number)

Note:  
 The Hatched Suffix  
 indicates the use of a  
 Design Feature.  
 eg. 7/1#  
 eg. SL 20.519# xx

**COORDINATE DATUM NOTE:**

HORIZONTAL COORDINATES(E,N) SUPPLIED ARE MAPPING GRID OF AUSTRALIA(MGA), ZONE 56 BASED ON THE UNIVERSAL TRANSVERSE MERCATOR PROJECTION AND THE GEOCENTRIC DATUM OF AUSTRALIA 1994.  
 HORIZONTAL DATUM DERIVED FROM PM33280, E 492232.092, N 7002357.242.  
 LEVELS SUPPLIED ARE ON THE AUSTRALIAN HEIGHT DATUM(AHD)  
 LEVEL DATUM DERIVED FROM PSM108673 RL 17.338 (AHD)

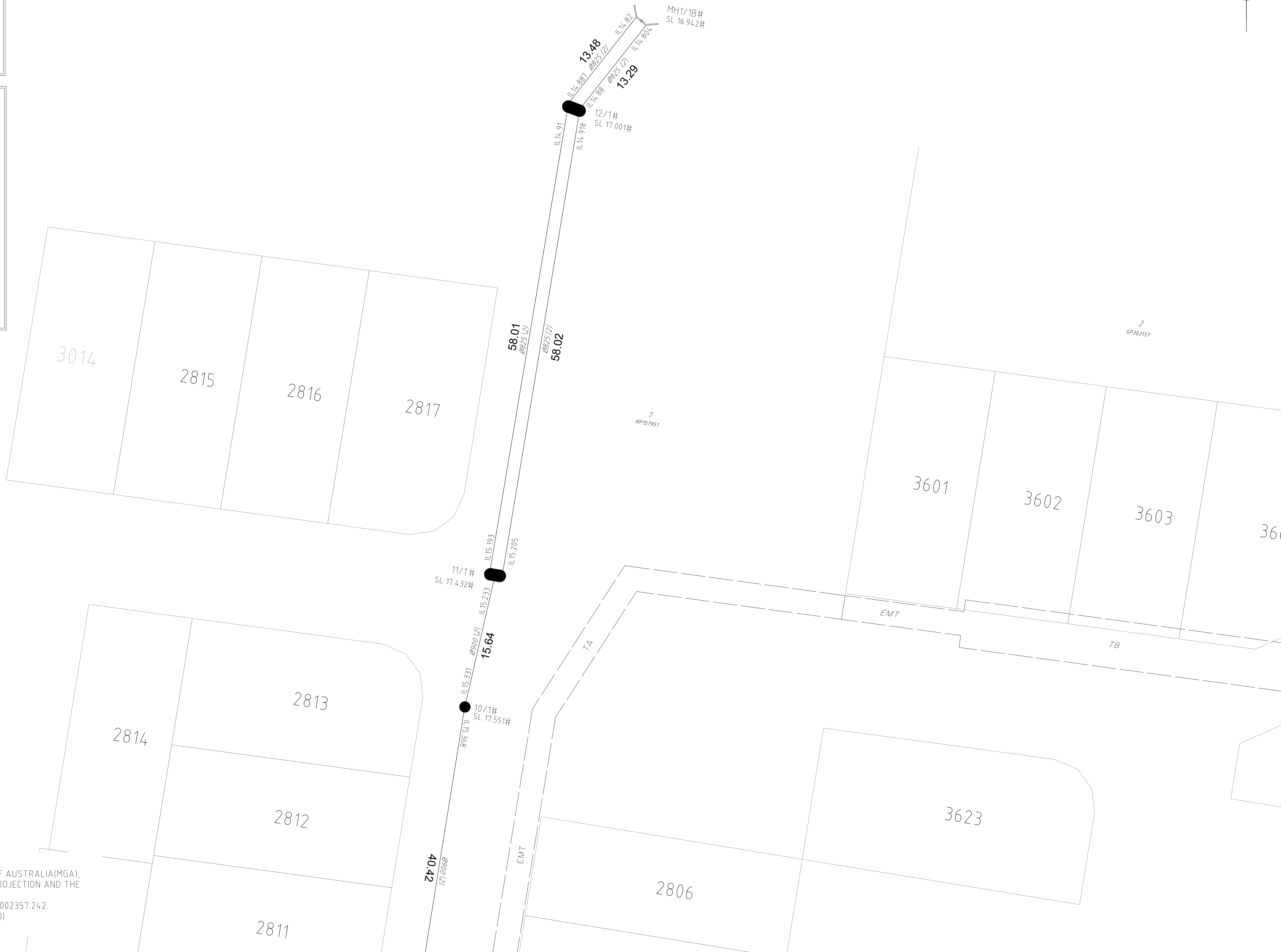

DRAWING REVISIONS		REFERENCE DRAWINGS		DESIGN FILE No.	DESIGNED	BRISBANE (07) 3668 4300 MACKAY (07) 4957 6700 veris.com.au ACN 615 735 727 Veris Australia Pty Ltd	WHITSUNDAYS (07) 4943 6900 CAIRNS (07) 4252 8400 veris.com.au ACN 615 735 727 Veris Australia Pty Ltd	MORETON BAY REGIONAL COUNCIL CABOOLTURE DISTRICT OFFICE 2 HASKING STREET CABOOLTURE QLD 4510 PO BOX 159 CABOOLTURE QLD 4510 Telephone: (07) 5433 0100 Fax: (07) 5433 4000	MBRC SUBDIVISION REFERENCE	
REV.	REVISION DESCRIPTION	DRG. No.	DESCRIPTION	CONSTRUCT. No.	DATE				DA/28428/2013/VCHG/1	No. 2 OF 4 PLANS
A	Original	24/11/2022		431132-27-ASW B	JMc					
B	Final	17/04/2023			23/11/2022					
				LOG BOOK	CHECKED	MJT				
				LEVEL DATUM	AHD	17/04/2023				
				DATUM	PM 108673	RL 17.338				
SCALE 1:250						ORIGINAL SIZE A1				
1	2	3	4	5	6	7	8	9	10	11
									431132-27-ASW	B



**REGISTERED SURVEYOR'S CERTIFICATION**

We, **VERIS AUSTRALIA PTY LTD**, hereby certify that the vertical and horizontal locations and dimensions shown on this plan are a true and correct record and were located by survey.

*Alastair Byrom*  
 Delegate Cadastral Surveyor (sig) Reg. Surveyor No. **6448** Date: **19/04/23**

**ENGINEER'S CERTIFICATION**

I, **BRENT MILTON**, being a Certificated/Registered Engineer and  
*(Engineer's Name)*  
 duly authorised representative of **COVEY ASSOCIATES PTY LTD**  
*(Consulting firm or company)*

Hereby:-  
 • certify the information contained in this drawing/file is an accurate "as constructed" representation of the works;  
 • accept responsibility for the "as constructed" information contained in this drawing/file; and  
 • acknowledge the "as constructed" information contained in this drawing/file may be relied on by the Council and others.

Certification for Stage **27** by *(Signature)* on **10.05.2023**  
*(Date)*

for **COVEY ASSOCIATES PTY LTD**  
*(Company Name)*  
 Registered Professional Engineering Company of Queensland **27473**  
*(Number)*

••Note  
 The hatched suffix  
 indicates the use of a  
 Design Feature.  
 eg. 7/1#  
 eg. SL 20.519# ••

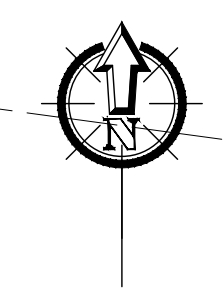

**COORDINATE DATUM NOTE:**  
 HORIZONTAL COORDINATES(E,N) SUPPLIED ARE MAPPING GRID OF AUSTRALIA(MGA), ZONE 56 BASED ON THE UNIVERSAL TRANSVERSE MERCATOR PROJECTION AND THE GEOCENTRIC DATUM OF AUSTRALIA 1994.  
 HORIZONTAL DATUM DERIVED FROM PM33280, E 492232.092, N 7002357.242.  
 LEVELS SUPPLIED ARE ON THE AUSTRALIAN HEIGHT DATUM(AHD)  
 LEVEL DATUM DERIVED FROM PSM108673 RL 17.338 (AHD)

DRAWING REVISIONS		REFERENCE DRAWINGS		DESIGN FILE No.	DESIGNED	 BRISBANE (07) 3999 9100 MACKAY (07) 4597 8700 WHITSUNDAYS (07) 4462 8800 CARRUM (07) 4252 9400 veris.com.au ACN 615 735 727 Veris Australia Pty Ltd <th rowspan="4">                   MORETON BAY REGIONAL COUNCIL                  CABOOLTURE DISTRICT OFFICE                  2 HASKING STREET CABOOLTURE QLD 4510                  PO BOX 159 CABOOLTURE QLD 4510                  Telephone: (07) 5433 0100                  Fax: (07) 5433 4000              <th colspan="2">MBRC SUBDIVISION REFERENCE</th> </th>	 MORETON BAY REGIONAL COUNCIL CABOOLTURE DISTRICT OFFICE 2 HASKING STREET CABOOLTURE QLD 4510 PO BOX 159 CABOOLTURE QLD 4510 Telephone: (07) 5433 0100 Fax: (07) 5433 4000 <th colspan="2">MBRC SUBDIVISION REFERENCE</th>	MBRC SUBDIVISION REFERENCE			
REV.	REVISION DESCRIPTION	DRG. No.	DESCRIPTION	CONSTRUCT. No.	DATE			DA/28428/2013/VCHG/1			
A	Original	24/11/2022		431132-27-ASW B	DRAWN			JMc	No. 3 OF 4 PLANS		
B	Final	17/04/2023			DATE			23/11/2022	DRAWING NUMBER	REV.	
				FIELD BOOK	DATE	MJT	431132-27-ASW	B			
				LOG BOOK	CHECKED						
				LEVEL DATUM	AHD	DATE					
				DATUM	PM 108673	RL 17.338					
SCALE 1:250						ORIGINAL SIZE A1					

