



LEGEND:-

- Water
- Stormwater
- Sewer
- Batters
- Retaining Wall
- Design Wall Heights
- Driveway

STAGE 11B



Design surface contours based on AHD datum at an interval of 0.5m are shown as: 34.0

Fill Areas are shown as:

Depth of Fill shown as: +0.2m Fill

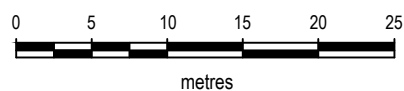

SCALE 1:500 IS APPLICABLE ONLY TO THE ORIGINAL SHEET SIZE. (A3)

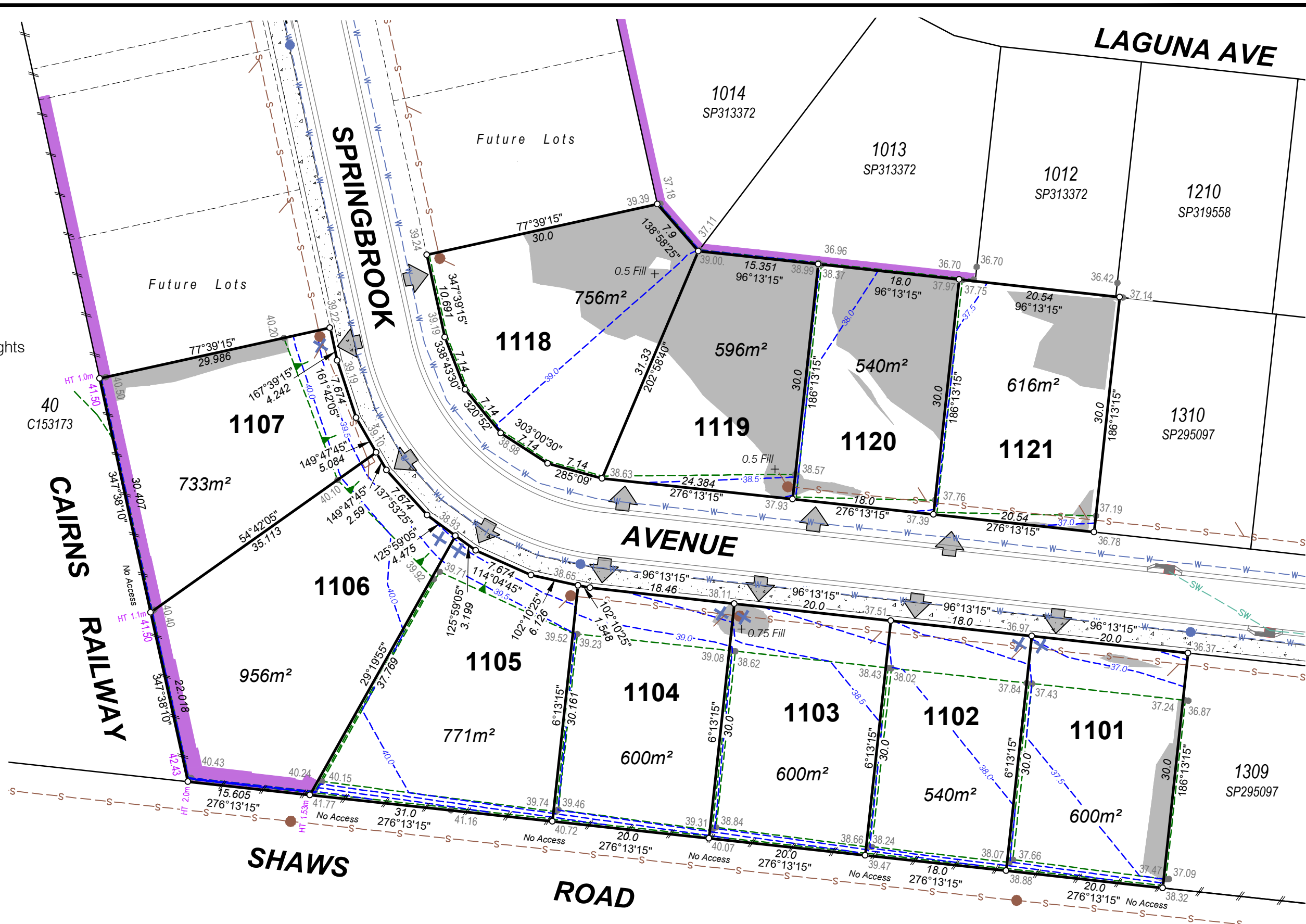

IMPORTANT NOTES:-

- These notes are an integral part of this plan.
- This plan has been prepared for Easterly Projects Pty Ltd for the purposes of A Disclosure Plan Under the Land Sales Act 1984.
- It is not to be used by any other person or corporation or for any other purposes and is subject to the following limitations:
- The Lot dimensions and area shown hereon are subject to final field survey and also to the requirements of Council and any other authority which may have requirements under any relevant legislation.
- Design contours, fill areas, sewerage, storm water drainage, roads and water reticulation are derived from the engineering design drawings by Jacobs Group (Australia) Pty Ltd and may differ from the as-constructed location.
- Builders must not build off the design information shown on this plan. A site survey is required.
- Compaction of earthworks shall be in accordance with the FNQROC Development Manual, Design Manual D2.08 / AS 3798.
- The Proposed Lot is currently described as part of Lot 2 on SP319558, situated off Springbrook Avenue, Redlynch.
- Building location envelopes and setbacks are yet to be approved.

AMENDMENTS	PROJECT MANAGER I Doust	
	CHECKED <i>Jon Pault</i>	
	COMPILED KJB	13/12/21
CAD REF 5159-278.DWG	SHEET 1 OF SHEETS 1	SHEET SIZE A3

EASTERLY PROJECTS PTY LTD

DISCLOSURE PLAN

Proposed Lots 1101-1107 & 1118-1121

Sheet 1 of 1
Springbrook, Redlynch

RPS

RPS Australia East Pty Ltd
ACN 140 292 762

135 Abbott St
PO Box 1949
CAIRNS QLD 4870

T +61 7 4031 1336
F +61 7 4031 2942
W rpsgroup.com.au

SCALE **1:500** DATE 20-12-2021 DRAWING NO. **5159-278 A** ISSUE