

# The Ashton

Best designs. Best packages. Best prices.

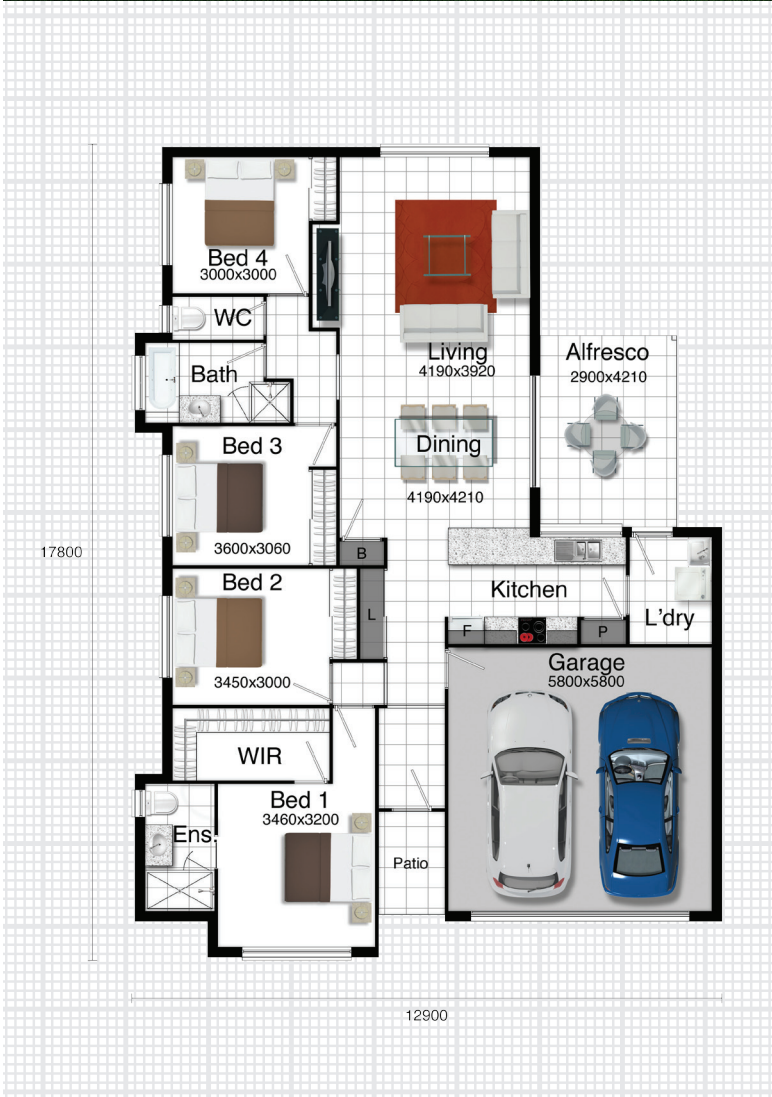

Lot 1105 Crabapple Court  
Riverparks Estate  
Land Size: 527m<sup>2</sup>  
HOUSE AND LAND PRICE  
**\$376,995**

Living area	141.4 m <sup>2</sup>
Garage Area	36.6 m <sup>2</sup>
Alfresco Area	12.0 m <sup>2</sup>
Porch Area	4.0 m <sup>2</sup>
Total Area	194.0 m <sup>2</sup>

## PACKAGE INCLUDES:



- 25 Year Structural Guarantee\*
- Smart Stone Kitchen bench
- 2590mm High Ceilings
- Quality European Appliances
- Designs can be modified to suit individual needs
- 6 Star Energy Rating
- Quality Carpets & Tiles
- Colourbond Roof

Katherine Kleidon  
0417 769 118

