

Elite SOIL TESTING PTY LTD

Po Box 644, Kallangur Qld 4503
Ph. 3285 5583 Fax. 3285 5589

Email: admin@elitesoiltesting.com.au Website: www.elitesoiltesting.com.au

ABN: 97 113 538 748

ACN: 113 538 748

RIVERPARKS STAGE 8B2, 15A & DOBSON LANE Pauls Road, Upper Caboolture



Report on
Level 1 Earthworks Control
Geotechnical Inspection & Testing

Report Date: 24 May 2018
Job Number: J17179
Contractor: GW Civil Contracting
Superintendent: Sheehy & Partners
Principal Client: Northerly Projects

Table of Contents

SCOPE OF WORKS	3
THE PROJECT	3
FILL FOUNDATION	4
CONTROLLED FILL.....	4
FIELD DENSITY LOCATIONS	4
TEST RESULTS.....	4
CONCLUSION	5

APPENDIX A Site Progress Photos

APPENDIX B Controlled Fill Certificates

Job No.J17179
Thursday, 24 May 2018

GW Civil Contracting
PO BOX 177
Northgate, Qld, 4013

Attn: Pascal Tydink

RE: Riverparks Estate Stage 8B2, 15A & Dobson Lane Roundabout.

SCOPE OF WORKS

Elite Soil Testing was commissioned by GW Civil Contracting to provide Geotechnical Inspection and Testing on a “Level 1” basis in accordance with SECTION 8 of AS 3798-2007 “Guidelines on Earthworks for Commercial and Residential Developments”.

Site supervision, inspections and testing were carried out in compliance with the Australian Standard, project specifications and the local authority testing requirements.

This report is provided to show conformity with the “Level 1” specification for the various stages of earthworks associated with this project.

THE PROJECT

The project encompasses the construction of 9 residential allotments with its associated infrastructure including roadwork’s, stormwater and sewer drainage plus water reticulation. Earthworks operations were carried out between 30th April and 21st May 2018.

Some filling was required as part of the development and for this work the scope of the Level 1 inspection and testing was:

- (i) Carry out inspection of proposed cut and fill areas to check adequacy of fill foundation.
- (ii) Provide supervision and compaction control testing of placed fill materials.

FILL FOUNDATION

The stripped surfaces of proposed fill areas were inspected and proof rolled prior to placement and compaction of fill. Compliance of the fill foundation and approval to begin filling these areas was granted when inspections showed completion of removal of topsoil, organics and remediation of any uncontrolled fill material as well as soundness (minimum deflection) under test rolling.

CONTROLLED FILL

Onsite fill material was considered suitable for use as controlled fill. This fill material was moisture conditioned and placed in near-horizontal layers of uniform thickness across the fill area. Each fill layer was placed and compacted using the following plant; backho, grader, moxy truck, pad foot roller and water truck.

FIELD DENSITY LOCATIONS

Field density test locations were selected at random, and staggered across the fill areas. The test locations as described on the Field Density Report were not professionally surveyed and should only be considered as the approximate location.

TEST RESULTS

Test results on controlled fill placed under supervision indicate that the minimum specification requirement of greater than 95% Dry Density Ratio in accordance with AS1289 .5.3.1, 5.8.1, 5.1.1, 5.4.1 & 2.1.1 (standard compaction test) was achieved. Refer to Annex A for Individual Lot Certificates.

CONCLUSION

We confirm that vegetation, topsoil, and any unsuitable materials were removed and that a sound base for the proposed filling was provided. We confirm that the results obtained from compaction control testing, together with observations made during supervised earthworks operations, indicate that the fill materials placed to design levels can be termed as "Controlled Fill".

The limitations on Level 1 Certification unless otherwise stated in this report do not address or include; slope stability, soft, reactive or contaminated soils, backfill to trenches and/or retaining walls and topsoil placed after controlled filling. Information provided in this report is based on that which has been provided by the client and third parties. Elite Soil Testing have relied upon this information and presumed its accuracy. If further assumptions are to be added Elite Soil Testing reserves the right to amend this report.

This report is produced for the clients and the relevant statutory authorities. It is not to be used or released in whole or in part for any manner by any other party.



Anthony Jeffrey
Managing Director

Appendix A

SITE PROGRESS PHOTOS





Appendix B

CONTROLLED FILL CERTIFICATES

Elite SOIL TESTING PTY LTD

Po Box 644, Kallangur Qld 4503

Ph. 3285 5583 Fax. 3285 5589

Email: admin@elitesoiltesting.com.au Website: www.elitesoiltesting.com.au

ABN: 97 113 538 748

ACN: 113 538 748

**CERTIFICATE OF CONTROLLED FILLING
EARTHWORKS OPERATIONS
(AS3798-2007 SECTION 8 – Level 1)
Riverparks Stage 8B2, 15A & Dobson Lane Roundabout
Pauls Road, Upper Caboolture.
Lot 1501**

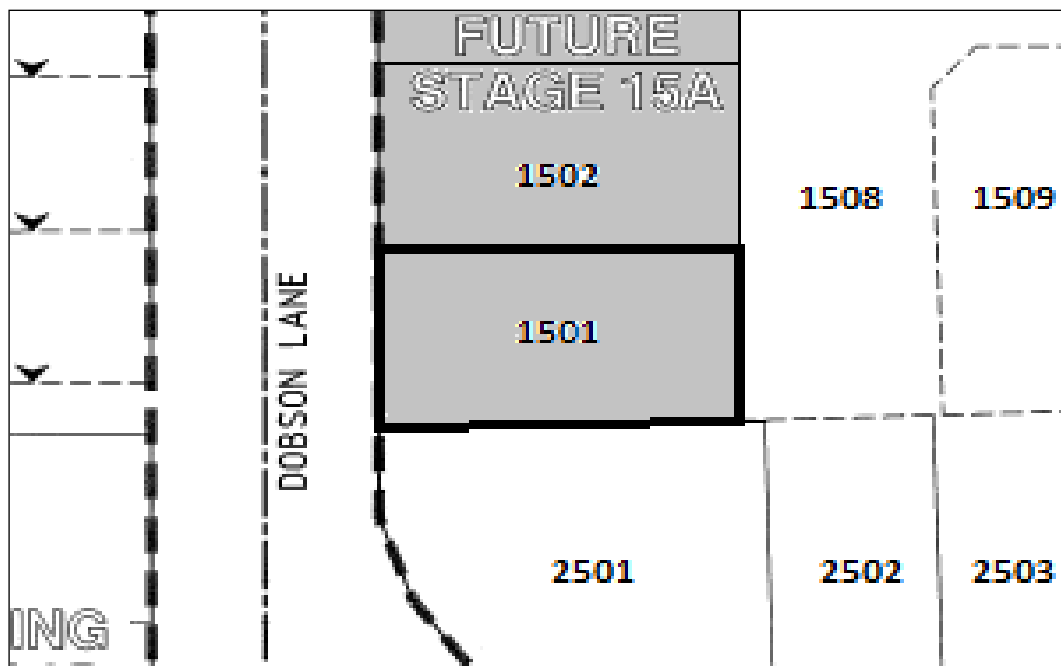

 Approximate lateral extent and maximum depth of controlled filling to 1.0m.
Level 1 Certification is limited to within this area.

Filling in the areas defined above have been carried out to meet the requirements of the specification and Level 1 Certification as per AS3798 – 2007 “Guidelines on Earthworks for Commercial and Residential Developments” and is considered to be ‘Controlled Fill’ as defined in AS2870 “Residential Slabs & Footings”.

A geotechnical site investigation and foundation design for the specific ground conditions should be carried out on this lot prior to building, when house type and location is known.

Anthony Jeffrey
Managing Director

Elite SOIL TESTING PTY LTD

Po Box 644, Kallangur Qld 4503

Ph. 3285 5583 Fax. 3285 5589

Email: admin@elitesoiltesting.com.au Website: www.elitesoiltesting.com.au

ABN: 97 113 538 748

ACN: 113 538 748

**CERTIFICATE OF CONTROLLED FILLING
EARTHWORKS OPERATIONS
(AS3798-2007 SECTION 8 – Level 1)
Riverparks Stage 8B2, 15A & Dobson Lane Roundabout
Pauls Road, Upper Caboolture.
Lot 1502**

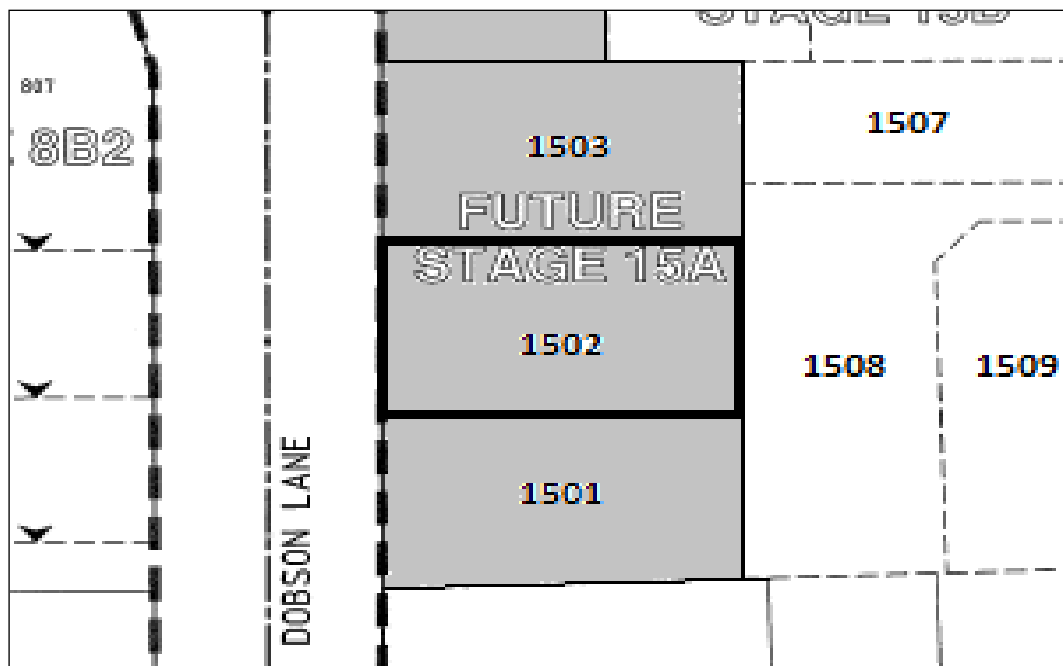

 Approximate lateral extent and maximum depth of controlled filling to 1.0m.
Level 1 Certification is limited to within this area.

Filling in the areas defined above have been carried out to meet the requirements of the specification and Level 1 Certification as per AS3798 – 2007 “Guidelines on Earthworks for Commercial and Residential Developments” and is considered to be ‘Controlled Fill’ as defined in AS2870 “Residential Slabs & Footings”.

A geotechnical site investigation and foundation design for the specific ground conditions should be carried out on this lot prior to building, when house type and location is known.

Anthony Jeffrey
Managing Director

Elite SOIL TESTING PTY LTD

Po Box 644, Kallangur Qld 4503

Ph. 3285 5583 Fax. 3285 5589

Email: admin@elitesoiltesting.com.au Website: www.elitesoiltesting.com.au

ABN: 97 113 538 748

ACN: 113 538 748

**CERTIFICATE OF CONTROLLED FILLING
EARTHWORKS OPERATIONS
(AS3798-2007 SECTION 8 – Level 1)
Riverparks Stage 8B2, 15A & Dobson Lane Roundabout
Pauls Road, Upper Caboolture.
Lot 1503**

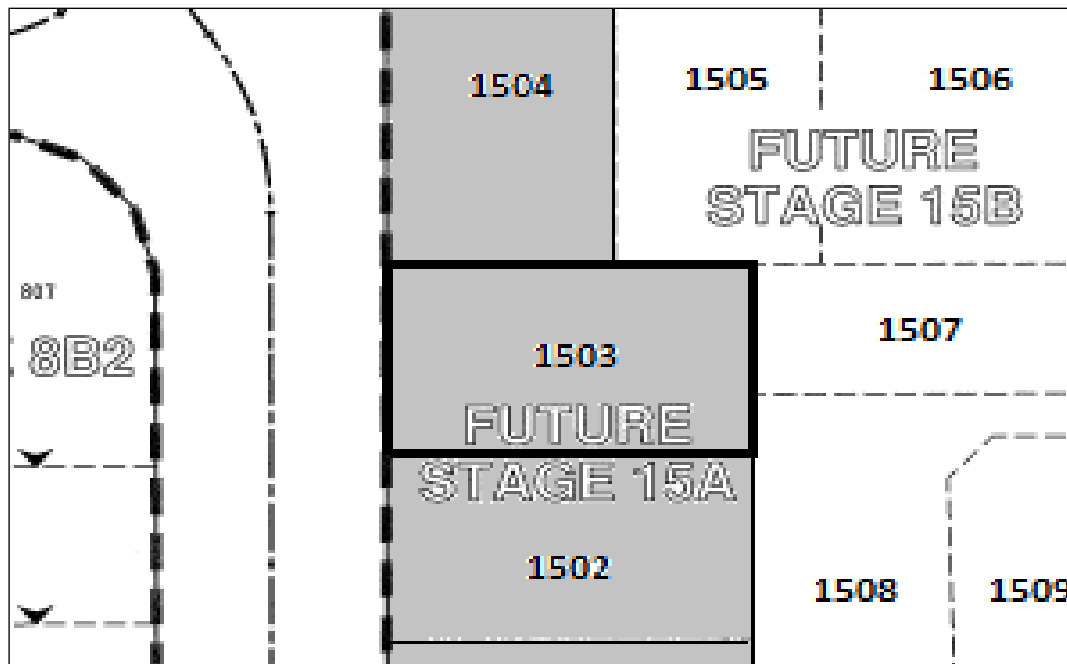

 Approximate lateral extent and maximum depth of controlled filling to 1.0m.
Level 1 Certification is limited to within this area.

Filling in the areas defined above have been carried out to meet the requirements of the specification and Level 1 Certification as per AS3798 – 2007 “Guidelines on Earthworks for Commercial and Residential Developments” and is considered to be ‘Controlled Fill’ as defined in AS2870 “Residential Slabs & Footings”.

A geotechnical site investigation and foundation design for the specific ground conditions should be carried out on this lot prior to building, when house type and location is known.

Anthony Jeffrey
Managing Director

Elite SOIL TESTING PTY LTD

Po Box 644, Kallangur Qld 4503

Ph. 3285 5583 Fax. 3285 5589

Email: admin@elitesoiltesting.com.au Website: www.elitesoiltesting.com.au

ABN: 97 113 538 748

ACN: 113 538 748

**CERTIFICATE OF CONTROLLED FILLING
EARTHWORKS OPERATIONS
(AS3798-2007 SECTION 8 – Level 1)
Riverparks Stage 8B2, 15A & Dobson Lane Roundabout
Pauls Road, Upper Caboolture.
Lot 1504**

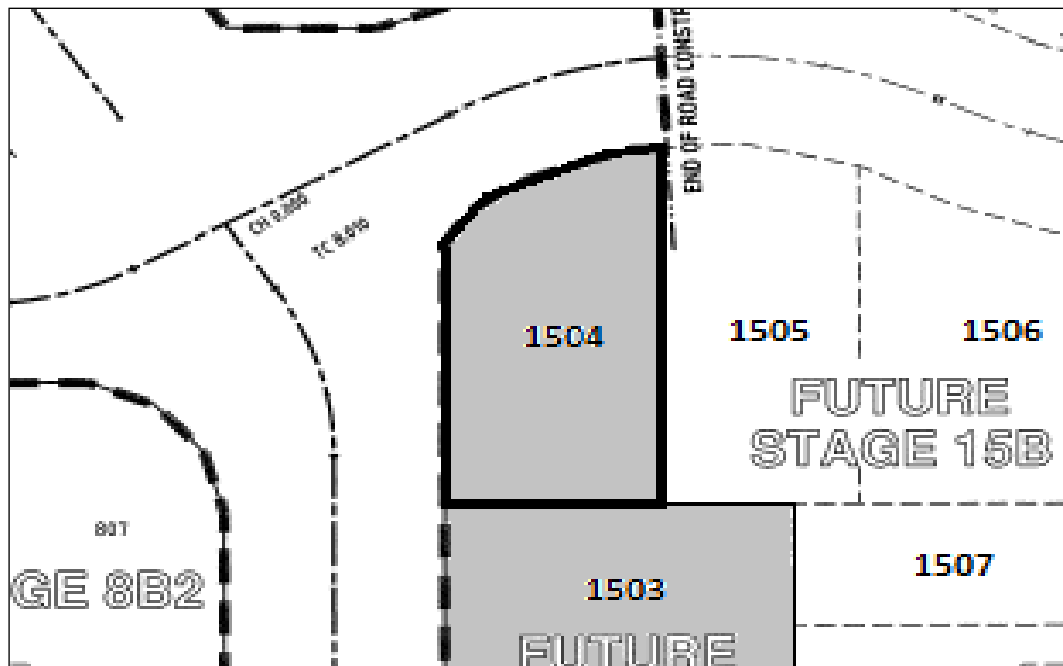

 Approximate lateral extent and maximum depth of controlled filling to 1.0m.
Level 1 Certification is limited to within this area.

Filling in the areas defined above have been carried out to meet the requirements of the specification and Level 1 Certification as per AS3798 – 2007 “Guidelines on Earthworks for Commercial and Residential Developments” and is considered to be ‘Controlled Fill’ as defined in AS2870 “Residential Slabs & Footings”.

A geotechnical site investigation and foundation design for the specific ground conditions should be carried out on this lot prior to building, when house type and location is known.

Anthony Jeffrey
Managing Director